

iKleen2 Remote Control

User Instructions

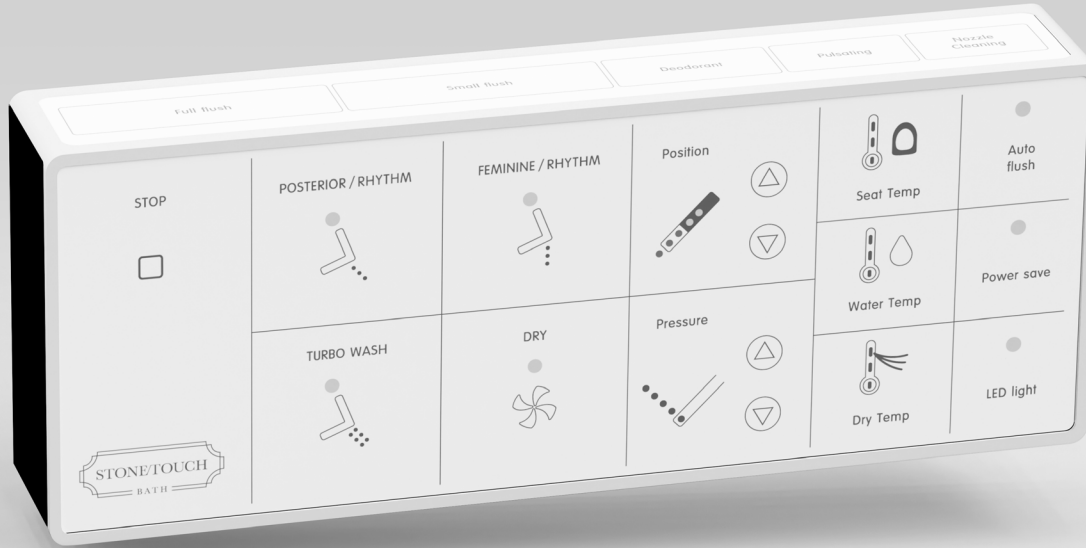

Full Flush

Activates the full or small flush.

Small Flush

Activates the feminine intimacy spray nozzle

Deodorant

Removes the odor from inside the bowl

Pulsating

When one of the jets is in operation, pressing this button adds alternating pressure to what is already happening.

Nozzle Cleaning

Moves the nozzle forward for easy cleaning.

Stop – Press the STOP button to halt the current function in use.

Posterior / Rythm



Feminine / Rythm



To activate this sub-function, the customer must have already started the jet (Posterior or Feminine). Once this operation has been started, pressing the same button again activates the Rhythm function (forward/backward).

Position



Adjusts the nozzle to your comfort position (5 settings)

Seat Temp



Adjusts the seat temperature (3 settings).

Auto Flush ON/OFF

Activates the auto-flush function. Distinguishes urine and feces

Turbo Wash



Activates the powerful water spray function.

Dry



Activates the dry function after any wash cycle.

Pressure



Adjusts the water pressure to your comfort level for any wash cycle.

Water Temp



Adjusts the water temperature for any of the water cycles.

Power saving ON /OFF

Activates the power saving mode.

Dry Temp



Adjusts the drying temperature (3 settings).

Lighting ON/OFF

Activates the automatic LED light function inside the toilet bowl. Can be used as a night light.

