

RUNWAY WALLMOUNT COLUMN
#RUNC14

FEATURES

- Made in Italy
- Marine grade, crafted for resistance to humidity and moisture
- BLUM soft-close door hinges with 110-degree opening
- Reversible: opens from left or right
- 4 fixed glass shelves
- Luxurious matte charcoal interior
- Carved integrated drawer pulls
- Fluted texture on front panels
- Broaden your options and customize your column size by joining 2 units together (included screws)
- CARB certified, thermo-sculpted MDF panels
- FSC sourced, TSCA compliant (USA and CAN approved)

Note: Optional legs available



FINISHES



CERTIFICATIONS

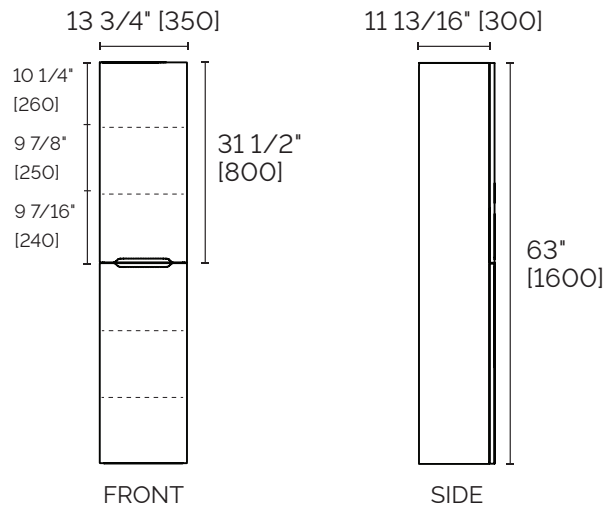

LEG SET NOT INCLUDED (OPTIONAL)



StoneTouch cannot be held responsible for any technical or typographical errors or omissions contained within this document and reserves the right to make changes without prior notice.